

PCB LAYOUT

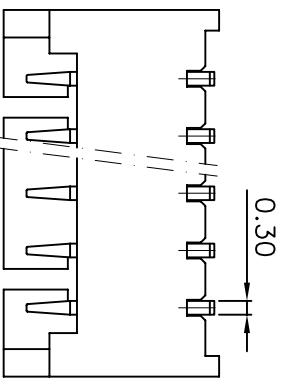
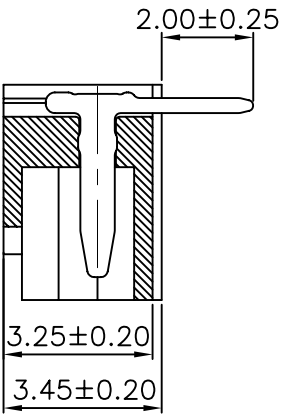
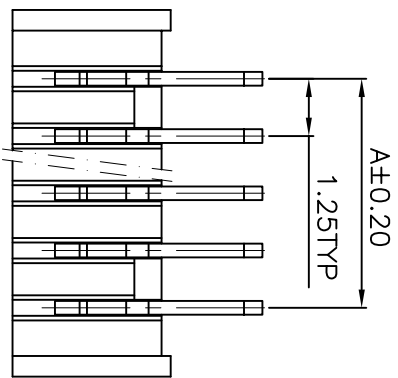

SPECIFICATIONS

Voltage ratings: 125V AC, DC
 Current rating: 1A, AC, DC (AWG#26)
 Withstanding voltage: 500V AC/minute
 Insulation resistance: 100M Ω min
 Temperature range: -40 °C - +85°C
 Contact resistance: 20m Ω max

WAFER

Part No.: SCT1251WR-XXP
 Poles: 2-16
 Material: Nylon 46, UL94V-0
 Contact: Brass, Tin plated
 Q'TY: 1, 000 pcs/bag

PART NO	DIMENSION	
	A	B
SCT1251WR-02	1.25	4.25
SCT1251WR-03	2.50	5.50
SCT1251WR-04	3.75	6.75
SCT1251WR-05	5.00	8.00
SCT1251WR-06	6.25	9.25
SCT1251WR-07	7.50	10.50
SCT1251WR-08	8.75	11.75
SCT1251WR-09	10.00	13.00
SCT1251WR-10	11.25	14.25
SCT1251WR-11	12.50	15.50
SCT1251WR-12	13.75	16.75
SCT1251WR-13	15.00	18.00
SCT1251WR-14	16.25	19.25
SCT1251WR-15	17.50	20.50
SCT1251WR-16	18.75	21.75

REV	DATE	MODIFICATION DESCRIPTION	CHANGE	APPROVE	OPERATION	DRAW	SCALE
0	05/12/27	NEW			~ 10 ±0.15	Micky.Liu	mm
					20 ~ 30 ±0.30	Judy.Huang	A4
					30 ~ Angle ± 2'	Hellen.Li	1/1

SCONDAR 森康达电子有限公司
 SCONDAR ELECTRONIC LIMITED

PART NO. SCT1251WR-XXP
 TITLE: MX1.25 90C WAFER
 DRAWING NO. SCT1251