

PCB Layout

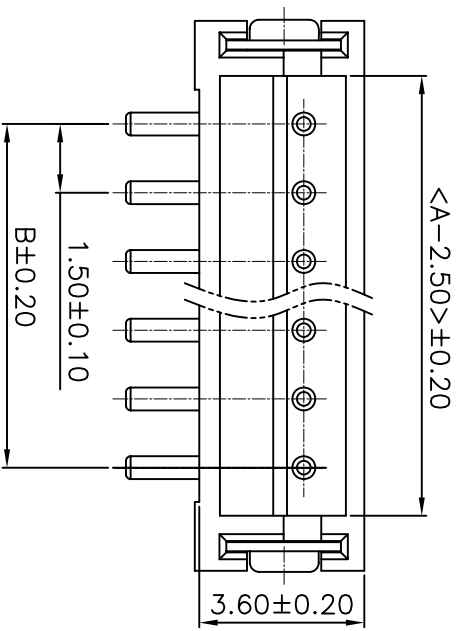

SPECIFICATIONS

Voltage rating: 100V AC, DC
 Current rating: 1A, AC, DC (AMG#26)
 Withstanding Voltage: 500V AC/minute
 Insulation resistance: 500M Ω min
 Temperature range: -25 $^{\circ}$ C - +85 $^{\circ}$ C
 Contact resistance: 20m Ω max

WAFER
 Part No.: SCT1501WV-S-XXPT
 Poles: 02-16
 Material: Nylon 46, UL94V-0
 Contact: Brass, Tin plated
 Q' TY: 1000 pcs/bag

PART NO.	Dimensions	
	A	B
SCT1501WV-S-02 PT	6.00	1.50
SCT1501WV-S-03 PT	7.50	3.00
SCT1501WV-S-04 PT	9.00	4.50
SCT1501WV-S-05 PT	10.50	6.00
SCT1501WV-S-06 PT	12.00	7.50
SCT1501WV-S-07 PT	13.50	9.00
SCT1501WV-S-08 PT	15.00	10.50
SCT1501WV-S-09 PT	16.50	12.00
SCT1501WV-S-10 PT	18.00	13.50
SCT1501WV-S-11 PT	19.50	15.00
SCT1501WV-S-12 PT	21.00	16.50
SCT1501WV-S-13 PT	22.50	18.00

REV	DATE	MODIFICATION DESCRIPTION	CHANGE	APPROVE	DATE	SCALE	UNIT	PART NO.	TITLE:	DRAWING NO.
0	05/12/27	NEW				A4	mm	SCT1501WV-S-XXPT	ZH1.5 SMT 180C WAFER	SCT1501WV-S

SCON DAR 森康达电子有限公司
 SCON DAR ELECTRONIC LIMITED

1 2 3 4 5 6 7 8 9 10