

PCB LAYOUT

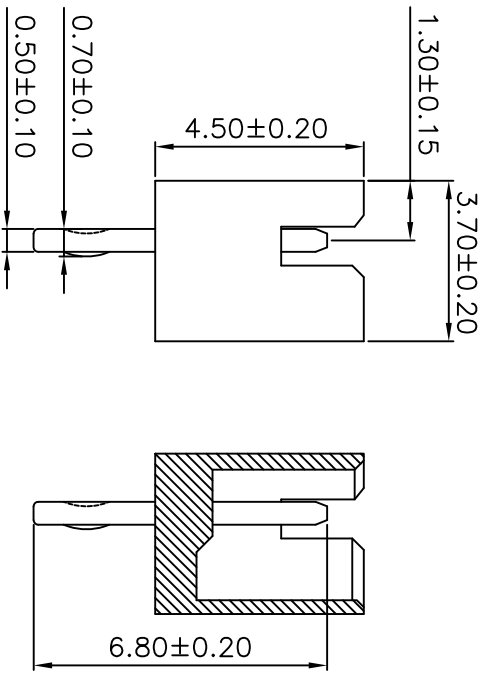
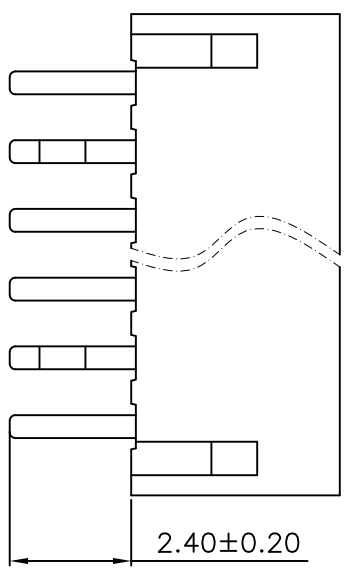
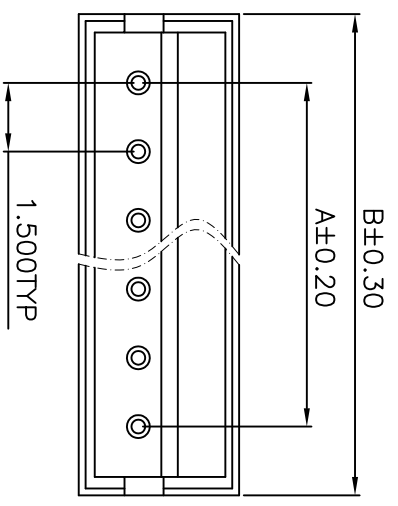

PART NO	DIMENSION	
	A	B
SCT1501WV-02 PB	1.50	4.50
SCT1501WV-03 PB	3.00	6.00
SCT1501WV-04 PB	4.50	7.50
SCT1501WV-05 PB	6.00	9.00
SCT1501WV-06 PB	7.50	10.50
SCT1501WV-07 PB	9.00	12.00
SCT1501WV-08 PB	10.50	13.50
SCT1501WV-09 PB	12.00	15.00
SCT1501WV-10 PB	13.50	16.50
SCT1501WV-11 PB	15.00	18.00
SCT1501WV-12 PB	16.50	19.50
SCT1501WV-13 PB	18.00	21.00
SCT1501WV-14 PB	19.50	22.50
SCT1501WV-15 PB	21.00	24.00
SCT1501WV-16 PB	22.50	25.50

SPECIFICATIONS

Voltage rating: 100V AC, DC  
 Current rating: 1A, AC, DC (AWG#26)  
 Withstanding Voltage: 500V AC/minute  
 Insulation resistance: 500M  $\Omega$  min  
 Temperature range: -25°C - +85°C  
 Contact resistance: 20m $\Omega$  max  
 WAFER  
 Part No: SCT1501WV-XXPB  
 Poles: 02-16  
 Material: Nylon 46, UL94V-0  
 Q' TY: 1000 pcs/bag

OPERATION		DRAW		SCALE	
~ 10	$\pm 0.15$	Judy Huang	2006/05/02	mm	
DESIGN		CHECK		UNIT	
20 ~ 30	$\pm 0.30$	Micky.Liu	2006/05/02	SIZE	A4
ANGLE		APPROVE		SHEET	1/1
30 ~	$\pm 0.50$	Hellen.Li	2006/05/02	TITLE:	ZH1.5 180C WF
Angle	$\pm 2'$			DRAWING NO.	SCT1501
DIM	TOL				
1	2	3	4	5	6
DATE	MODIFICATION DESCRIPTION	CHANGE	APPROVE	APPROVE	
05/12/27	NEW				

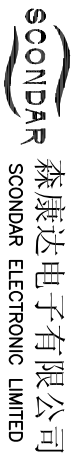

森康达电子有限公司  
SCONBAR ELECTRONIC LIMITED

PART NO. SCT1501WV-XXPB

TITLE: ZH1.5 180C WF

DRAWING NO. SCT1501