

PCB LAYOUT

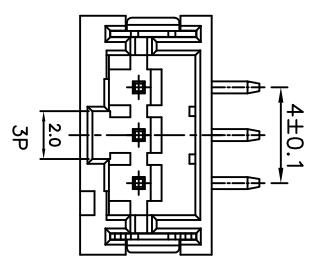
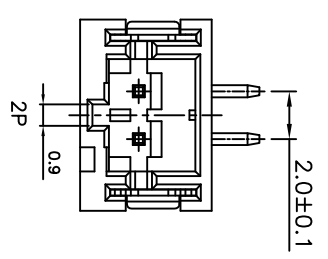
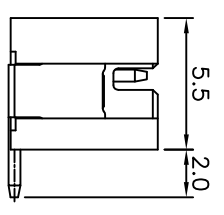
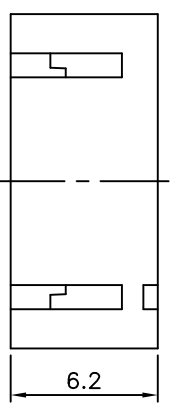
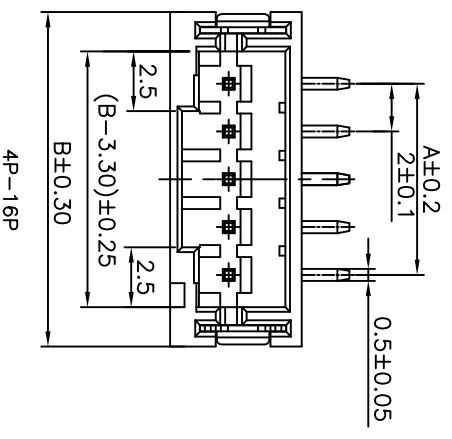

| PART NO.        | Dimensions |       |
|-----------------|------------|-------|
|                 | A          | B     |
| SCT2001WV-S-02P | 2.00       | 8.00  |
| SCT2001WV-S-03P | 4.00       | 10.00 |
| SCT2001WV-S-04P | 6.00       | 12.00 |
| SCT2001WV-S-05P | 8.00       | 14.00 |
| SCT2001WV-S-06P | 10.00      | 16.00 |
| SCT2001WV-S-07P | 12.00      | 18.00 |
| SCT2001WV-S-08P | 14.00      | 20.00 |
| SCT2001WV-S-09P | 16.00      | 22.00 |
| SCT2001WV-S-10P | 18.00      | 24.00 |
| SCT2001WV-S-11P | 20.00      | 26.00 |
| SCT2001WV-S-12P | 22.00      | 28.00 |
| SCT2001WV-S-13P | 24.00      | 30.00 |
| SCT2001WV-S-14P | 26.00      | 32.00 |
| SCT2001WV-S-15P | 28.00      | 34.00 |
| SCT2001WV-S-16P | 30.00      | 36.00 |

SPECIFICATIONS

Voltage Rating: 100V AC/DC  
 Current Rating: 2A AC/DC  
 Withstanding Voltage: 800V AC/minute  
 Insulation Resistance: 1,000MΩ min.  
 Temperature Range: -25° C - +85° C  
 Contact Resistance: 20mΩ max

WAFER  
 Part No: SCT2001WV-S-XXP  
 Poles: 2-16  
 Material: Nylon 9T, UL94V-0  
 Pin: Brass, Tin plated

|           |         |                          |         |         |            |             |                 |
|-----------|---------|--------------------------|---------|---------|------------|-------------|-----------------|
| OPERATION | ~ 10    | ±0.15                    | DRAW    | YANG    | 2016.04.14 | SCALE       |                 |
| DESIGN    | 20 ~ 30 | ±0.30                    | DESIGN  |         |            | UNIT        | mm              |
| CHECK     | 30 ~    | ±0.50                    | CHECK   | MICKY   | 2016.04.14 | SIZE        | A4              |
| APPROVE   | Angle   | ± 2'                     | APPROVE | ALLEN   | 2016.04.14 | SHEET       | 1/1             |
| DATE      | DM      | TOL                      | CHANGE  |         |            | PROJ.       |                 |
| 05/12/27  |         |                          | NEW     |         |            | DRAWING NO. | SCT2001WV-S-XXP |
| REV       | DATE    | MODIFICATION DESCRIPTION | CHANGE  | APPROVE |            |             |                 |

