

B \pm 0.25
A \pm 0.20

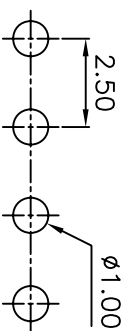

PCB LAYOUT

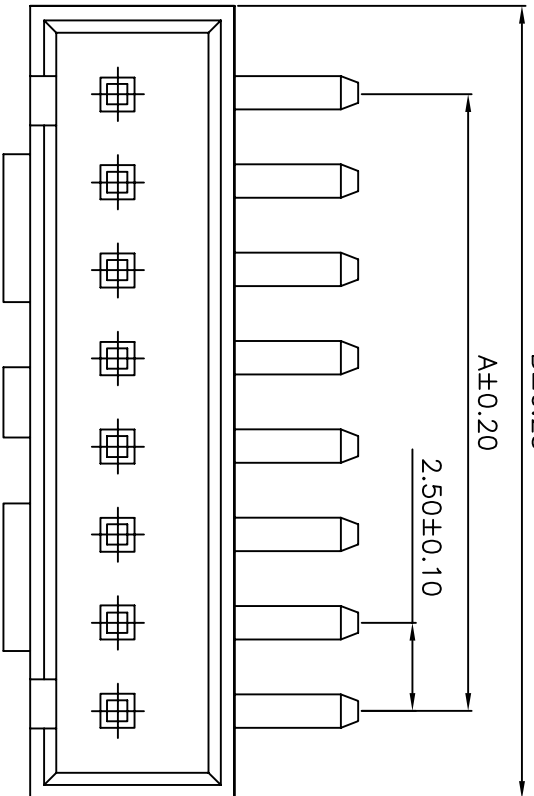
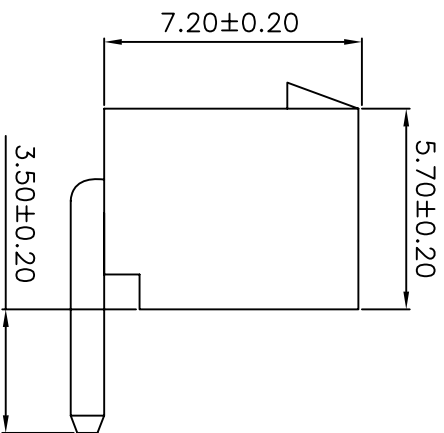

PART NO	DIMENSION	
	A	B
SCT2502WR-02	2.50	7.50
SCT2502WR-03	5.00	10.00
SCT2502WR-04	7.50	12.50
SCT2502WR-05	10.00	15.00
SCT2502WR-06	12.50	17.50
SCT2502WR-07	15.00	20.00
SCT2502WR-08	17.50	22.50
SCT2502WR-09	20.00	25.00
SCT2502WR-10	22.50	27.50
SCT2502WR-11	25.00	30.00
SCT2502WR-12	27.50	32.50
SCT2502WR-13	30.00	35.00
SCT2502WR-14	32.50	37.50
SCT2502WR-15	35.00	40.00
SCT2502WR-16	37.50	42.50

SPECIFICATIONS

Voltage Rating: 250V AC/DC
 Current Rating: 3A AC/DC
 Withstanding Voltage: 1000V AC/minute
 Insulation Resistance: 1000M Ω min.
 Temperature Range: -25° C - +85° C
 Contact Resistance: 20m Ω max

WAFER

Part No: SCT2502WR-XXP
 Poles: 2-16
 Material: Nylon 66, UL94V-2
 Pin: Brass, Tin plated

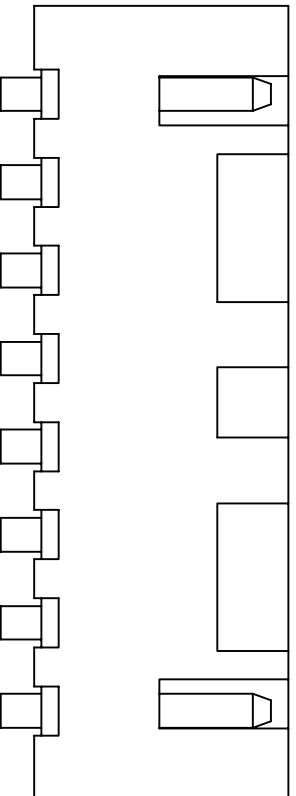

OPERATION	~ 10	\pm 0.15	DRAW	CHENA	05/12/27	SCALE	mm	 森康达电子有限公司 SCONDA ELECTRONIC LIMITED	
DESIGN	20 ~ 30	\pm 0.30	CHECK	MICKY	05/12/28	UNIT	A4		
ANGLE	30 ~	\pm 0.50	APPROVE	HELLEN	05/12/28	SIZE	1/1		
REV	DATE	MODIFICATION DESCRIPTION	CHANGE	APPROVE		SHEET	1/1	TITLE:	XA2.5 90C WAFER
1						PROJ.		DRAWING NO.	SCT2502