

A-A

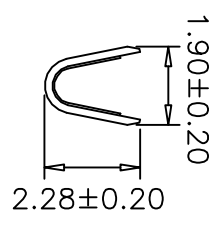

B-B

**SPECIFICATIONS**  
 Voltage Rating: 600V AC/DC  
 Current Rating: 9A AC/DC  
 Withstanding Voltage: 1500V AC/minute  
 Insulation Resistance: 1000MΩ min.  
 Temperature Range: -25° C - +85° C  
 Contact Resistance: 20mΩ max

**TERMINAL**  
 Part No: SCT4201MT  
 Wire Range: AWG#16-#24 (OD3.1mm max)  
 Material: Phosphor Bronze  
 Finish: Tin Plated  
 Thickness: 0.2mm  
 Q'TY: 5, 000PCS/Reel

REV	DATE	MODIFICATION DESCRIPTION	CHANGE	APPROVE	OPERATION	DRAW	JUDY	SCALE	森康达电子有限公司 S'CONDAR ELECTRONIC LIMITED	
0	05/12/27	NEW			~ 10 ±0.15	DESIGN		mm	PART NO.	SCT4201MTPH
					20 ~ 30 ±0.30	CHECK	JET YU	A4	TITLE:	MOLEX4.2 MALE TERMINAL
					30 ~ Angle ± 2'	APPROVE	HELLEN	1/1	DRAWING NO.	SCT4201
					DIM TOL		2015.06.07	PROJ.		
							2015.06.07			