

P.C.B LAYOUT

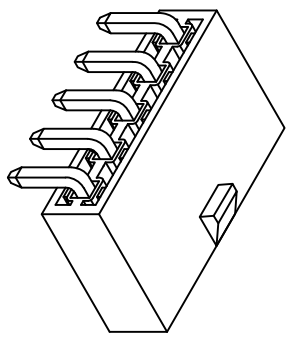
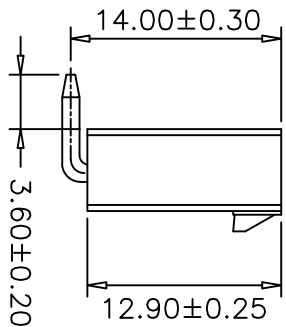
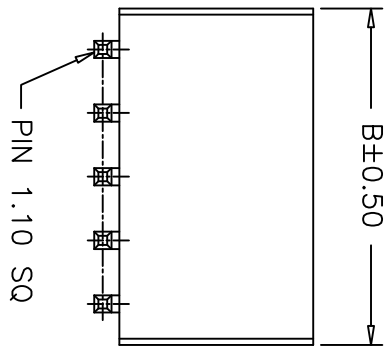

SPECIFICATIONS
 Voltage Rating: 600V AC/DC
 Current Rating: 9A AC/DC
 Withstanding Voltage: 1500V AC/minute
 Insulation Resistance: 100MΩ min.
 Temperature Range: -25° C - +85° C
 Contact Resistance: 20mΩ max

WAFER
 Part No: SCT4201WR-XXP
 Pole: 02-06
 Material: Nylon 66, UL94V-2
 Pin: Brass, Tin plated

PART NO.	Dimensions	
	A	B
SCT4201WR-02P	4.20	9.60
SCT4201WR-03P	8.40	13.80
SCT4201WR-04P	12.60	18.00
SCT4201WR-05P	16.80	22.20
SCT4201WR-06P	21.00	26.40

OPERATION	~ 10	±0.15	DRAW	YANG	2016.10.27	SCALE	
	20 ~ 30	±0.30	DESIGN			UNIT	mm
	30 ~	±0.50	CHECK	MICKY	2016.10.27	SIZE	A4
Angle			APPROVE	ALLEN	2016.10.27	SHEET	1/1
DM						PROJ.	◆
TOL							
APPROVE							
CHANGE							
APPROVE							
DESCRIPTION	NEW						
DATE	05/12/27						
REV	0						

SCONDAR 森康达电子有限公司
 S'CONDAR ELECTRONIC LIMITED

PART NO. SCT4201WR-XXP
 TITLE: MOLEX4.2 90C WAFER
 DRAWING NO. SCT4201