

SPECIFICATIONS
 Voltage Rating: 250V AC/DC
 Current Rating: 10A AC/DC
 Withstanding Voltage: 1500V AC/minute
 Insulation Resistance: 1000MΩ min.
 Temperature Range: -25° C - +85° C
 Contact Resistance: 20mΩ max

TERMINAL
 Part No: SCT5083MT
 Wire Range: AWG#14-#20 (OD3.3mm max)
 Material: Brass
 Finish: Tin plated
 Thickness: 0.25
 Q/TY: 8,000PCS/Reel

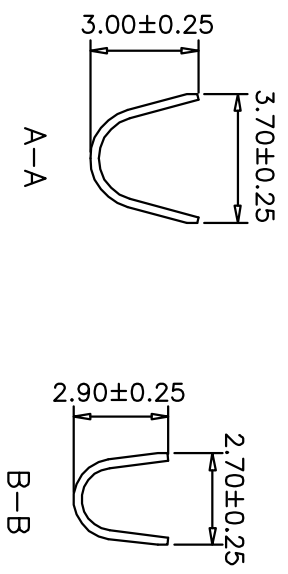

OPERATION		~ 10	±0.15	DRAW		JUDY	2007.05.09	SCALE	SCT 森康达电子有限公司	
DESIGN		20 ~ 30	±0.30	CHECK		MICKY	2007.05.09	UNIT	S'CONDAR ELECTRONIC LIMITED	
ANGLE		30 ~	±0.50	APPROVE		HELLEN	2007.05.09	SIZE	SCT5083MT	
DIM		± 2'		APPROVE				SHEET	MOLEX8981 MALE Terminal	
TOL				APPROVE				PROJ.	SCT5083	
REV	DATE	MODIFICATION DESCRIPTION		CHANGE	APPROVE			DRAWING NO.		
0	05/12/27	NEW						TITLE:		